

ECONOMIC PALLET & CONTAINER TRANSPORTERS - C-ATH-4048

APPROX WEIGHT: 216.34 lbs.
 DOES NOT INCLUDE WEIGHT OF POWER OR PACKAGING!!!

*** ANY ADDITIONS, DELETIONS, OR OMISSIONS MUST BE CORRECTED ON THIS DRAWING AS THIS DRAWING WILL BE CONSIDERED ALL INCLUSIVE ***
 ALL GRAPHICS PROVIDED ARE FOR REFERENCE ONLY. IF CERTAIN DIMENSIONS ARE CRITICAL PLEASE VERIFY THOSE DIMENSIONS WITH YOUR SALESPERSON

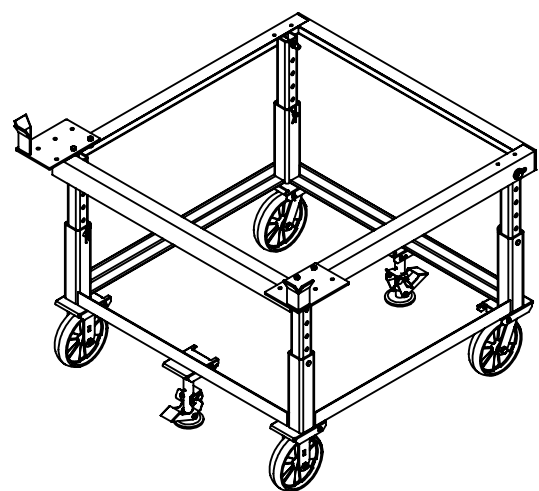
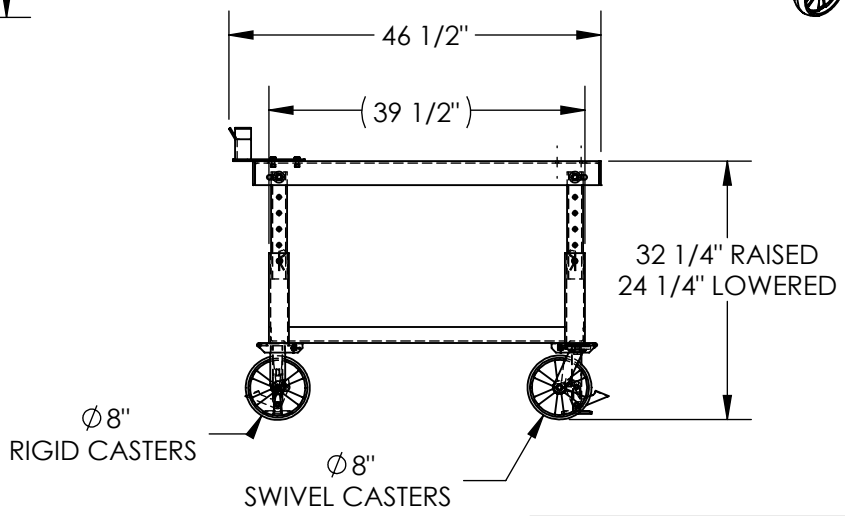
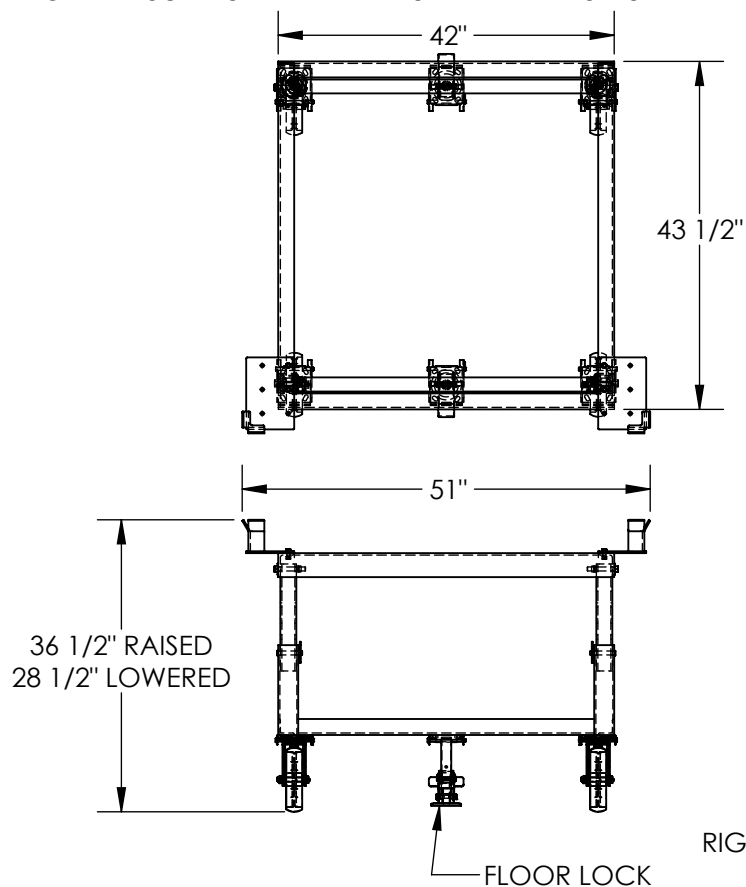

DIMENSION TOLERANCE ± 1/4"

STANDARD FEATURES

- MODEL NUMBER IS C-ATH-4048
- OVERALL WIDTH IS 51"
- OVERALL LENGTH IS 46 1/2"
- OVERALL RAISED HEIGHT: 36 1/2"
- OVERALL LOWERED HEIGHT: 28 1/2"
- DECK RAISED HEIGHT: 32 1/4"
- DECK LOWERED HEIGHT: 24 1/4"
- MAX CAPACITY IS 4,000 LBS
- Ø8" x 2" GLASS FILLED NYLON CASTERS
- (2) RIGID & (2) SWIVEL
- FITS MIN. PALLET SIZE 40" X 40"
- FITS MAX. PALLET SIZE 48" X 48"
- INCLUDES (2) CORNER GUARDS
- TOUGH BAKED IN POWDERCOATED BLUE FINISH
- QTY. 2: FLOOR LOCKS

SPECIAL FEATURES

NONE

APPROVAL

I, THE UNDERSIGNED, AGREE THAT THE PRODUCT AS REPRESENTED SATISFIES DESIGN AND DIMENSION REQUIREMENTS. I ALSO ACKNOWLEDGE MY DUTY TO CONFIRM PRODUCT AND INSTALLATION COMPLIANCE WITH ALL APPLICABLE FEDERAL, STATE AND LOCAL REGULATIONS AND STANDARDS.

ANY MODIFIED UNITS ARE NON-RETURNABLE

[] As drawn [] As marked

Signed: _____ Date: _____

Printed Name: _____

LEAD TIME WILL START UPON RECEIPT OF SIGNED APPROVAL DRAWING

FOR INTERNAL USE ONLY PROJECT SIGN OFF	
SALES	
ENG.	
FAB.	
POWER	

DISTRIBUTOR'S NAME:		P.O.#
VESTIL MANUFACTURING		X
W.O.#		X
DRAWN BY: TAC	DATE: 11/08/2010	SALES: X
REFERENCE: X	SCALE: 1:24	FILE NAME:
QUOTED LEAD TIME: X	QUOTE # X	33-007-072